



CABINET LIGHTING

TASK LIGHTING
SERIES



CLASSIC LEVEL

Task Lighting

Phantom™ Classic TL Series light strips provide the ultimate performance and flexibility as a seamless, concealed low voltage linear lighting source. All Phantom TL Series lighting strips are manufactured to your exact specifications using a variety of custom metal glare shields, so that the light is always perfectly controlled while keeping the fixture out of sight. Lamping options include 3 watt, 5 watt, and 10 watt Xenon festoon lamps (rated for up to 20,000 hours) and LED lamps (rated for up to 40,000 hours). Energy-efficient 0.6 watt 12VAC LED lamps are ideal for applications where energy code compliance is an issue or a major consideration.

All lamping options are fully dimmable for achieving the perfect light level or to extend lamp life. Phantom TL series light strips are available in eight painted colors as well as premium metals, such as polished brass, satin brass, polished stainless steel, satin stainless steel, and natural copper. Phantom Lighting is all about seeing the light, not the fixture.

PHANTOM CLASSIC TL SERIES FEATURES

- Designed for task lighting applications in areas such as desks, under cabinets, butler's pantries, offices, and workstations.
- Paint grip galvanized metal trim with unique glare shields specifically designed for coves or any other indirect lighting applications
- Customizable wiring methods designed for all applications
- Multiple trim shapes available for custom applications for use above eye level
- LED and Xenon festoon lamping options
- ETL Listed, Miscellaneous fixtures, conforms to UL STD, 1598

TL Classic Series Exploded View

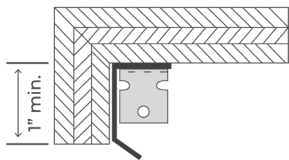

LIGHTING STRIP LOCATION

For best results, always mount the lights behind the front lip of the upper cabinet and use a matte finish on the back of the cabinet or wall to minimize glare and reflections. Note: stone finishes, such as granite, marble, and ceramic tile are notorious for reflecting lamp images from normal viewing angles.

LIGHTING STRIP TIP

When trim 1 or trim 2 are used, it may be necessary to field adjust lighting strips up or down to accommodate larger wood reveals and fine tune lighting coverage.

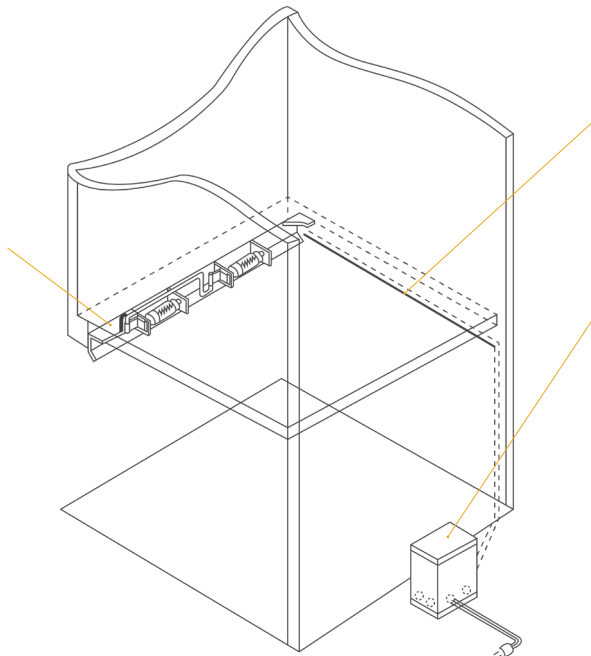
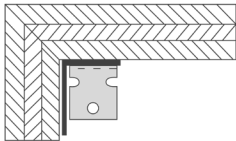

WIRE SLEEVE TIP

We recommend that you fabricate a small removable wood cover for the purpose of hiding the wires between the fixture and where the wire exits the wall. Most applications require an end feed connection.

TRANSFORMER (REMOTE MOUNT)

Magnetic transformers are sized to match the total wattage of your lighting load and come equipped with one or more secondary circuit breakers. (See driver sheet for more sizing information and amperage calculations).

DIMMER CONTROLS (BY OTHERS)

Magnetic low voltage transformers should always be used with a dimmer designated for magnetic or inductive loads. Electronic transformers should always be used with a dimmer designated for electronic loads.

Classic TL Series Trim Profiles

Choose your trim profile based on your mounting application and the level of glare desired.

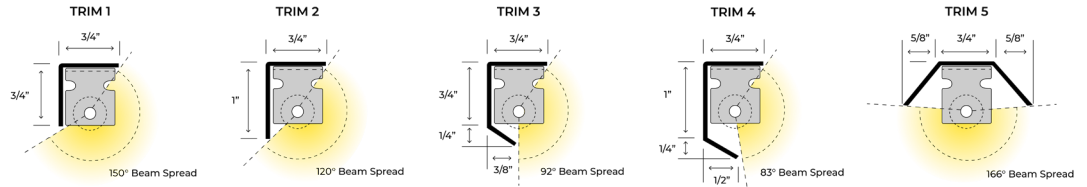

Classic TL Series Lamps

Xenon festoon lamps are available in 3 watt, 5 watt, and 10 watt, in both 12VAC and 24VAC. Xenon lamps (2,800°K) typically produce a whiter light and are used for display lighting. Average life for a Xenon festoon lamp is 20,000 hours. LED festoon lamps are available in a 0.6 watt, 12VAC or 24 VAC models in several popular color temperatures. LED festoon lamps produce very little forward throw heat, no UV rays, and have an average lamp life of 40,000 hours. LED festoon lamps are perfect for retrofit applications or new projects that require a bright, efficient light source in hard to reach areas.

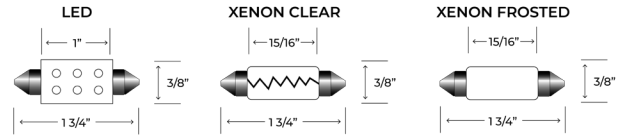

LED Kelvin Colors

2700 K 3500 K 5000 K

Xenon Kelvin Colors

2800K Clear 2800K Frost

Classic TL Series Transformers

TRANSFORMER SPECIFICATIONS

	20W	40W	60W	100W	150W	250W	500W
120/12VAC	MT20-12	MT40-12	MT60-12	MT100-12	MT150-12	MT250-12	MT500-12
120/24VAC	MT20-24	MT40-24	MT60-24	MT100-24	MT150-24	MT250-24	MT500-24
Max Wattage*	16	32	48	80	120	200	400
12V Breaker	Auto Reset	Auto Reset	Auto Reset	Auto Reset	Auto Reset	(1) 25A Push	(2) 25A Push
24V Breaker	Auto Reset	Auto Reset	Auto Reset	Auto Reset	Auto Reset	(1) 10A Push	(1) 25A Push
Height (H)	5.60"	5.60"	6.55"	6.55"	9.80"	6.75"	8.25"
Width (W)	2.10"	2.10"	2.55"	2.55"	3.00"	4.875"	5.62"
Depth (D)	2.10"	2.10"	2.55"	2.55"	3.00"	4.62"	5.25"
Weight (lbs)	2	2	3	7	7	13	19

*These numbers reflect the 20% safety factor that is recommended to avoid overload or nuisance tripping when selecting a transformer. (Wattage x 1.20)

To calculate amperage, divide total wattage by secondary voltage (Wattage/Voltage = Amperage).
To calculate wattage, divide amperage by secondary voltage (Amperage/Voltage = Wattage)

Phantom Classic Lighting Strips - Ordering Matrix
Sample Order Number: **TL-1-4-0.6-12-27-LL-12-FW-24**

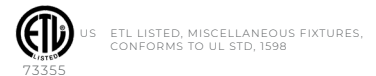

MODEL	TRIM PROFILE	LAMP SPACING	LAMP WATTAGE	OPERATING VOLTAGE	LAMP TYPE	LEAD TYPE*	LEAD LENGTH	TRIM COLOR	TRIM LENGTH
TL	1	4	0.6	12	27	LL	12"	FW	24"
TL	1	4"	0.6 - LED	12	27 - 2700K LED	LL - Leads Left	12"	FW - Flat White	Inches
	2	6"		24	35 - 3500K LED		18"	GW - Gloss White	
	3	CS -	3 - Xenon		50 - 5000K LED		24"	FB - Flat Black	Specify
	4	Custom Spacing	5 - Xenon		XFR - Frost Xenon	LR - Leads Right	36"	GB - Gloss Black	Your Trim
	5		10 - Xenon		XCL - Clear Xenon	DL - Double Leads	CUSTOM	LB - Light Beige	Length In
								MB - Medium Brown	Inches
								LA - Light Almond	
								UF - Unfinished	
								CC - Custom Color**	

*When facing application
**Contact factory for details